

Züllig pH-Probes PHBL-25 and PHZB2-25

Features

- Long term measurement stability
- Fast response
- Minimal drift
- User friendly, low maintenance
- Materials and configurations for most applications
- Optimal performance with Züllig transmitters

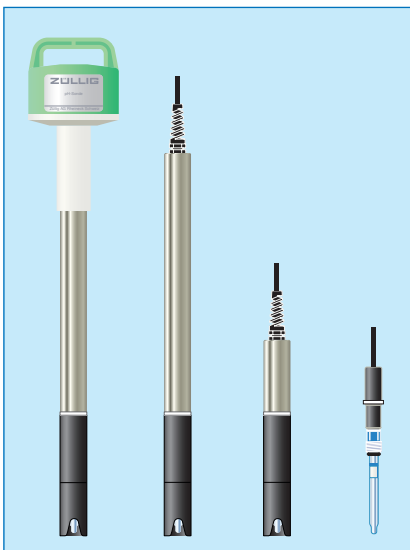

Mounting types

A large variety of probe configurations is available. This ensures suitability and ease of mounting into almost any application including insertion and pressurized applications through a ball valve. From left: Shaft version with hood, built-in type, submersion type and version with removable preamplifier¹⁾.

¹⁾ only PHBL-25

The combination of a pH sensor with a Züllig transmitter maximizes performance



Optimal performance with transmitter SPACE A/S or b-line II

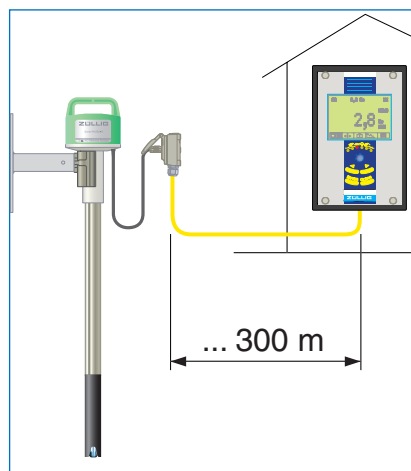

Large sensor/transmitter separation distances allowable

The fully encapsulated pre-amplifier delivers a low-resistance, stabil signal. This allows large separation between the pH sensor and the Züllig transmitter without signal degradation.

Applications

- Raw wastewater
- Activated sludge
- Drinking water, lakes and rivers
- Sewers and storm water tank
- Control and monitoring of industrial precipitation and pH neutralization plants
- Leachate monitoring

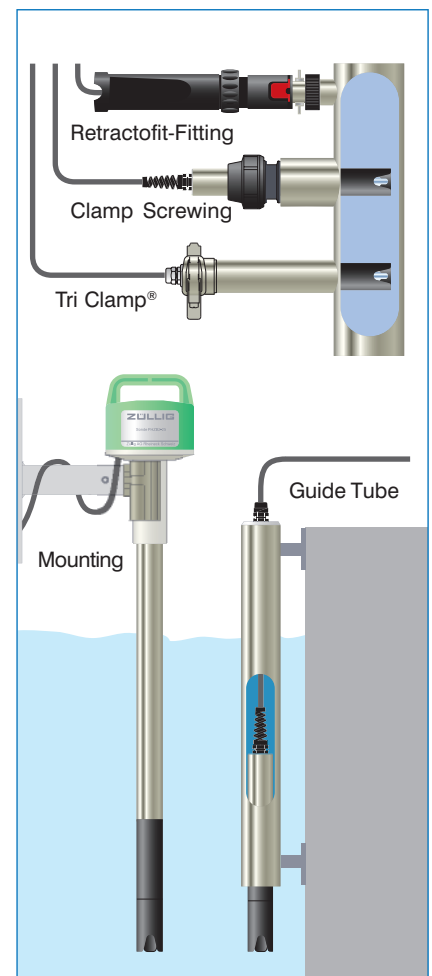

Additional possibilities with Z-KWA

Design

Compact Method of Construction

Easily changeable electrode

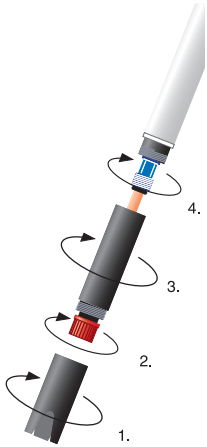

PHBL-25 and PHZB-25

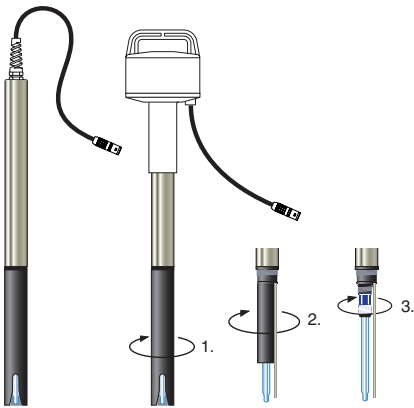

PHZB2-25

Accessories

- Plug system 2000
- Extension cable system 2000
- Multipurpose bracket
- Tri-Clamp® system (quick change)
- Ball valve system Z-KWA

Technical Data

Application Data

Measuring range	0...14 pH
Resolution of measurement	0,01 pH
Temperature compensation	PHBL -25 manual PHZB2-25 and PHZB-25 autom.
Temperature at use	0...60 °C
Pressure range	max. 6 bar
Minimum conductivity	0,5 mS/m (equals 5µS/cm)
Submerge at least	45 mm PHBL-25 and PHZB2-25 300 mm PHZB-25

Electrical Data

Voltage supply	24 VDC
Typical current draw	approx. 20 mA
Signal type	1...5 mA
Measurement of temperature	PT1000 (only PHZB2-/PHZB-25)
Cable	10 m (Züllig System 2000)
Plug	System 2000 (option)

Mechanical Data

Diameter	40 mm
Connection thread	G1"
Standard probe length	400 mm (with end piece) 1000 mm (with hood)
Special lengths (intervals of 100 mm)	300...4000 mm (with end piece) 500...4000 mm (with hood)
Short version PHBL-25 and PHZB-25	285 mm (with end piece) 543 mm (with hood)
Short version PHZB2-25	296 mm (with end piece) 554 mm (with hood)
Quick change version	Tri-Clamp® (option)

Material

Wetted Parts	PVC-U, glass, PBT Stainless steel DIN 1.4571 Stainless steel DIN 1.4435
Sealing	NBR, FKM, silicone or PTFE

Optimal Analysers for PHBL-25

SPACE A/S	Measuring type PHB
b-line II, b-line	Measuring type PHBL

Optimal Analysers for PHZB2-25 and PHZB-25

SPACE A/S and b-line II, b-line	Measuring type PHZ
---	--------------------

Subject to technical changes

1231e03 13/05/2003



Instrumentation for water and waste water control

Headquarter in Switzerland:
Züllig AG
CH-9424 Rheineck/Switzerland
Phone +41(0)71 886 91 11
Telefax +41(0)71 886 91 66
www.zuellig.ch
Representatives worldwide

Züllig Germany GmbH
Moselstrasse 27
D-63452 Hanau/Germany
Phone +49(0)6181/ 90 08 0
Telefax +49(0)6181/ 90 08 20